

Product Details

Product Range	GB Smooth
Texture Finish	Smooth
Colours	Pottery, Nickel, Pewter, Porcelain, Pebble & Limestone
Product Code	
Format	20.03B Half Bullnose
Place of Manufacture	Gympie, Queensland
Length (mm)	190
Width (mm)	190
Height (mm)	190
Size	190x190x190
Core Volume (%)	47
Characteristic Unconfined Compressive Strength (f'uc) MPa	-
Minimum Shell Thickness (mm)	30
Weight	8.7
Units Per Tonne	-
Units Per Pallet	90
Units per Square Metre	25
Durability Class	Exposure Grade
Slip Resistance	
Wall Mass Inc Hollow	-
Solar Absorption Rating	-
LRV	-
FRL	-
EPD	Yes
Declare	No
Recycled Content %	no

Diagram

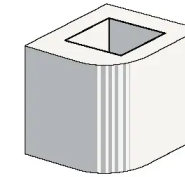

Fire Resistance Levels^

Structural Adequacy	60 to 240
Integrity	60
Insulation	60

Notes

-

Product Details

Product Range	GB Smooth
Texture Finish	Smooth
Colours	Pebble, Limestone, Porcelain, Pottery, Nickel & Pewter
Product Code	50.31 Capping Unit
Format	50.31 Capping Unit
Place of Manufacture	Gympie, Queensland
Length (mm)	390
Width (mm)	190
Height (mm)	40
Size	390x190x40
Core Volume (%)	-
Characteristic Unconfined Compressive Strength (f'uc) MPa	-
Minimum Shell Thickness (mm)	-
Weight	6.1
Units Per Tonne	-
Units Per Pallet	288
Units per Square Metre	-
Durability Class	Exposure Grade
Slip Resistance	
Wall Mass Inc Hollow	-
Solar Absorption Rating	-
LRV	-
FRL	-
EPD	Yes
Declare	No
Recycled Content %	-

Diagram

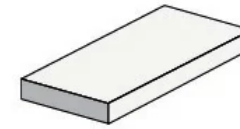

Fire Resistance Levels^

Structural Adequacy	-
Integrity	-
Insulation	-

Notes

-

Product Details

Product Range	GB Smooth
Texture Finish	Smooth
Colours	Limestone, Pottery, Pewter, Nickel, Porcelain & Pebble
Product Code	20.13 Half Lintel
Format	20.13 Half Lintel
Place of Manufacture	Gympie, Queensland
Length (mm)	190
Width (mm)	190
Height (mm)	190
Size	190x190x190
Core Volume (%)	-
Characteristic Unconfined Compressive Strength (f'uc) MPa	-
Minimum Shell Thickness (mm)	-
Weight	8.7
Units Per Tonne	-
Units Per Pallet	180
Units per Square Metre	-
Durability Class	Exposure Grade
Slip Resistance	
Wall Mass Inc Hollow	-
Solar Absorption Rating	-
LRV	-
FRL	-
EPD	Yes
Declare	No
Recycled Content %	-

Diagram

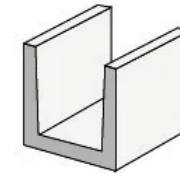

Fire Resistance Levels^

Structural Adequacy	-
Integrity	-
Insulation	-

Notes

-

Product Details

Product Range	GB Smooth
Texture Finish	Smooth
Colours	Pottery & Porcelain
Product Code	
Format	20.38 Half Height Sill
Place of Manufacture	-
Length (mm)	245
Width (mm)	190
Height (mm)	90
Size	245x190x90
Core Volume (%)	-
Characteristic Unconfined Compressive Strength (f'uc) MPa	-
Minimum Shell Thickness (mm)	-
Weight	8.3
Units Per Tonne	120.48192771084
Units Per Pallet	114
Units per Square Metre	-
Durability Class	Exposure Grade
Slip Resistance	
Wall Mass Inc Hollow	-
Solar Absorption Rating	-
LRV	-
FRL	-
EPD	Yes
Declare	No
Recycled Content %	no

Diagram

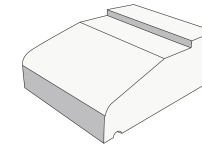

Fire Resistance Levels^

Structural Adequacy	60 to 240 (see notes)
Integrity	60
Insulation	60

Notes

-

Product Details

Product Range	GB Smooth
Texture Finish	Smooth
Colours	Porcelain, Nickel, Pebble, Limestone & Pewter
Product Code	10.25 Corner Return
Format	10.25 Corner Return
Place of Manufacture	Gympie, Queensland
Length (mm)	390
Width (mm)	90
Height (mm)	190
Size	390x90x190
Core Volume (%)	-
Characteristic Unconfined Compressive Strength (f'uc) MPa	-
Minimum Shell Thickness (mm)	-
Weight	13.3
Units Per Tonne	-
Units Per Pallet	120
Units per Square Metre	-
Durability Class	Exposure Grade
Slip Resistance	
Wall Mass Inc Hollow	-
Solar Absorption Rating	-
LRV	-
FRL	-
EPD	Yes
Declare	No
Recycled Content %	-

Diagram

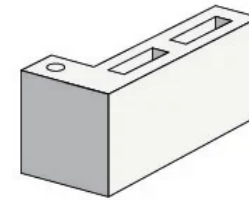

Fire Resistance Levels^

Structural Adequacy	-
Integrity	-
Insulation	-

Notes

-

Product Details

Product Range	GB Smooth
Texture Finish	Smooth
Colours	Porcelain, Pottery, Pebble, Limestone, Nickel & Pewter
Product Code	20.42 Channel
Format	20.42 Channel
Place of Manufacture	Gympie, Queensland
Length (mm)	390
Width (mm)	190
Height (mm)	190
Size	390x190x190
Core Volume (%)	-
Characteristic Unconfined Compressive Strength (f'uc) MPa	-
Minimum Shell Thickness (mm)	-
Weight	15.625
Units Per Tonne	-
Units Per Pallet	90
Units per Square Metre	-
Durability Class	Exposure Grade
Slip Resistance	
Wall Mass Inc Hollow	-
Solar Absorption Rating	-
LRV	-
FRL	-
EPD	Yes
Declare	No
Recycled Content %	-

Diagram

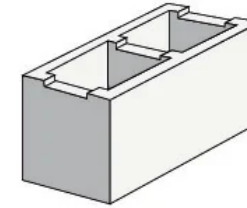

Fire Resistance Levels^

Structural Adequacy	-
Integrity	-
Insulation	-

Notes

-

Product Details

Product Range	GB Smooth
Texture Finish	Smooth
Colours	Nickel, Pebble, Porcelain, Pottery, Limestone & Pewter
Product Code	
Format	20.01B Standard Bullnose
Place of Manufacture	Gympie, Queensland
Length (mm)	390
Width (mm)	190
Height (mm)	190
Size	390x190x190
Core Volume (%)	47
Characteristic Unconfined Compressive Strength (f'uc) MPa	>15
Minimum Shell Thickness (mm)	30
Weight	15.6
Units Per Tonne	-
Units Per Pallet	180
Units per Square Metre	12.5
Durability Class	Exposure Grade
Slip Resistance	
Wall Mass Inc Hollow	-
Solar Absorption Rating	-
LRV	-
FRL	-
EPD	Yes
Declare	No
Recycled Content %	no

Diagram

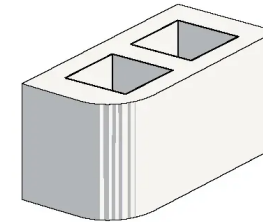

Fire Resistance Levels^

Structural Adequacy	60 to 240
Integrity	60
Insulation	60

Notes

-

Product Details

Product Range	GB Smooth
Texture Finish	Smooth
Colours	Porcelain, Limestone, Nickel, Pebble, Pewter & Pottery
Product Code	20.01 Standard
Format	20.01 Standard
Place of Manufacture	Gympie, Queensland
Length (mm)	390
Width (mm)	190
Height (mm)	190
Size	390x190x190
Core Volume (%)	-
Characteristic Unconfined Compressive Strength (f'uc) MPa	-
Minimum Shell Thickness (mm)	-
Weight	15.625
Units Per Tonne	-
Units Per Pallet	90
Units per Square Metre	-
Durability Class	Exposure Grade
Slip Resistance	
Wall Mass Inc Hollow	-
Solar Absorption Rating	-
LRV	-
FRL	-
EPD	Yes
Declare	No
Recycled Content %	-

Diagram

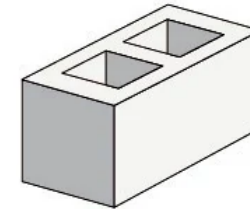

Fire Resistance Levels^

Structural Adequacy	-
Integrity	-
Insulation	-

Notes

-

Product Details

Product Range	GB Smooth
Texture Finish	Smooth
Colours	Porcelain, Limestone, Pebble, Pewter & Nickel
Product Code	
Format	30.42 Channel
Place of Manufacture	Gympie, Queensland
Length (mm)	390
Width (mm)	290
Height (mm)	190
Size	390x290x190
Core Volume (%)	-
Characteristic Unconfined Compressive Strength (f'uc) MPa	>15
Minimum Shell Thickness (mm)	-
Weight	20
Units Per Tonne	50
Units Per Pallet	60
Units per Square Metre	-
Durability Class	Exposure Grade
Slip Resistance	
Wall Mass Inc Hollow	-
Solar Absorption Rating	-
LRV	57.9
FRL	-
EPD	Yes
Declare	No
Recycled Content %	-

Diagram

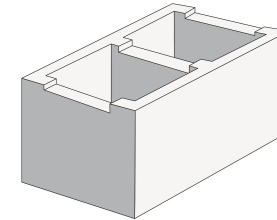

Fire Resistance Levels^

Structural Adequacy	-
Integrity	-
Insulation	-

Notes

-

Product Details

Product Range	GB Smooth
Texture Finish	Smooth
Colours	Porcelain, Limestone, Pebble, Pewter & Nickel
Product Code	10.03 Half
Format	10.03 Half
Place of Manufacture	Gympie, Queensland
Length (mm)	190
Width (mm)	90
Height (mm)	190
Size	190x90x190
Core Volume (%)	-
Characteristic Unconfined Compressive Strength (f'uc) MPa	-
Minimum Shell Thickness (mm)	-
Weight	4.9
Units Per Tonne	-
Units Per Pallet	360
Units per Square Metre	-
Durability Class	Exposure Grade
Slip Resistance	
Wall Mass Inc Hollow	-
Solar Absorption Rating	-
LRV	-
FRL	-
EPD	Yes
Declare	No
Recycled Content %	-

Diagram

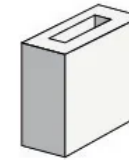

Fire Resistance Levels^

Structural Adequacy	-
Integrity	-
Insulation	-

Notes

-

Product Details

Product Range	GB Smooth
Texture Finish	Smooth
Colours	Pewter, Pebble, Limestone, Porcelain & Nickel
Product Code	30.02 Three Quarter
Format	30.02 Three Quarter
Place of Manufacture	Gympie, Queensland
Length (mm)	290
Width (mm)	290
Height (mm)	190
Size	290x290x190
Core Volume (%)	-
Characteristic Unconfined Compressive Strength (f'uc) MPa	-
Minimum Shell Thickness (mm)	-
Weight	16.7
Units Per Tonne	-
Units Per Pallet	80
Units per Square Metre	-
Durability Class	Exposure Grade
Slip Resistance	
Wall Mass Inc Hollow	-
Solar Absorption Rating	-
LRV	-
FRL	-
EPD	Yes
Declare	No
Recycled Content %	-

Diagram

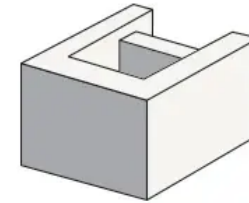

Fire Resistance Levels^

Structural Adequacy	-
Integrity	-
Insulation	-

Notes

-

Product Details

Product Range	GB Smooth
Texture Finish	Smooth
Colours	Pewter, Pottery, Limestone, Porcelain & Nickel
Product Code	20.73 Half Height Half
Format	20.73 Half Height Half
Place of Manufacture	Gympie, Queensland
Length (mm)	190
Width (mm)	190
Height (mm)	90
Size	190x190x90
Core Volume (%)	-
Characteristic Unconfined Compressive Strength (f'uc) MPa	-
Minimum Shell Thickness (mm)	-
Weight	4
Units Per Tonne	-
Units Per Pallet	360
Units per Square Metre	-
Durability Class	Exposure Grade
Slip Resistance	
Wall Mass Inc Hollow	-
Solar Absorption Rating	-
LRV	-
FRL	-
EPD	Yes
Declare	No
Recycled Content %	-

Diagram

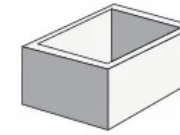

Fire Resistance Levels^

Structural Adequacy	-
Integrity	-
Insulation	-

Notes

-

Product Details

Product Range	GB Smooth
Texture Finish	Smooth
Colours	Limestone, Porcelain, Pewter, Pebble & Nickel
Product Code	20.20 Knockout
Format	20.20 Knockout
Place of Manufacture	Gympie, Queensland
Length (mm)	390
Width (mm)	190
Height (mm)	190
Size	390x190x190
Core Volume (%)	-
Characteristic Unconfined Compressive Strength (f'uc) MPa	-
Minimum Shell Thickness (mm)	-
Weight	15.2
Units Per Tonne	-
Units Per Pallet	90
Units per Square Metre	-
Durability Class	Exposure Grade
Slip Resistance	
Wall Mass Inc Hollow	-
Solar Absorption Rating	-
LRV	-
FRL	-
EPD	Yes
Declare	No
Recycled Content %	-

Diagram

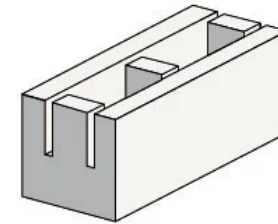

Fire Resistance Levels^

Structural Adequacy	-
Integrity	-
Insulation	-

Notes

-

Product Details

Product Range	GB Smooth
Texture Finish	Smooth
Colours	Pebble, Limestone, Pewter, Nickel, Porcelain & Pottery
Product Code	30.01 Standard
Format	30.01 Standard
Place of Manufacture	Gympie, Queensland
Length (mm)	390
Width (mm)	290
Height (mm)	190
Size	390x290x190
Core Volume (%)	-
Characteristic Unconfined Compressive Strength (f'uc) MPa	-
Minimum Shell Thickness (mm)	-
Weight	20
Units Per Tonne	-
Units Per Pallet	60
Units per Square Metre	-
Durability Class	Exposure Grade
Slip Resistance	
Wall Mass Inc Hollow	-
Solar Absorption Rating	-
LRV	-
FRL	-
EPD	Yes
Declare	No
Recycled Content %	-

Diagram

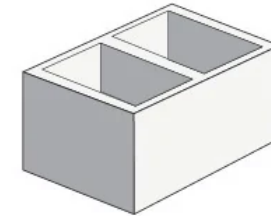

Fire Resistance Levels^

Structural Adequacy	-
Integrity	-
Insulation	-

Notes

-

Product Details

Product Range	GB Smooth
Texture Finish	Smooth
Colours	Limestone, Pewter, Pottery, Porcelain, Pebble & Nickel
Product Code	20.71 Half Height
Format	20.71 Half Height
Place of Manufacture	Gympie, Queensland
Length (mm)	390
Width (mm)	190
Height (mm)	90
Size	390x190x90
Core Volume (%)	-
Characteristic Unconfined Compressive Strength (f'uc) MPa	-
Minimum Shell Thickness (mm)	-
Weight	8
Units Per Tonne	-
Units Per Pallet	180
Units per Square Metre	-
Durability Class	Exposure Grade
Slip Resistance	
Wall Mass Inc Hollow	-
Solar Absorption Rating	-
LRV	-
FRL	-
EPD	Yes
Declare	No
Recycled Content %	-

Diagram

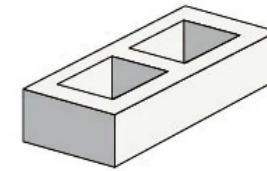

Fire Resistance Levels^

Structural Adequacy	-
Integrity	-
Insulation	-

Notes

-

Product Details

Product Range	GB Smooth
Texture Finish	Smooth
Colours	Pewter, Porcelain, Nickel, Pebble & Limestone
Product Code	10.725 Half Height Corner
Format	10.725 Half Height Corner10.725 Half Height Corner
Place of Manufacture	Gympie, Queensland
Length (mm)	390
Width (mm)	190
Height (mm)	90
Size	390x190x90
Core Volume (%)	-
Characteristic Unconfined Compressive Strength (f'uc) MPa	-
Minimum Shell Thickness (mm)	-
Weight	6.7
Units Per Tonne	-
Units Per Pallet	240
Units per Square Metre	-
Durability Class	Exposure Grade
Slip Resistance	
Wall Mass Inc Hollow	-
Solar Absorption Rating	-
LRV	-
FRL	-
EPD	Yes
Declare	No
Recycled Content %	-

Diagram

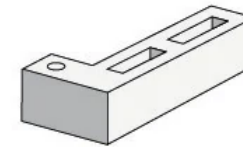

Fire Resistance Levels^

Structural Adequacy	-
Integrity	-
Insulation	-

Notes

-

Product Details

Product Range	GB Smooth
Texture Finish	Smooth
Colours	Nickel, Limestone, Porcelain, Pewter, Pottery & Pebble
Product Code	20.03 Half
Format	20.03 Half
Place of Manufacture	Gympie, Queensland
Length (mm)	190
Width (mm)	190
Height (mm)	190
Size	190x190x190
Core Volume (%)	-
Characteristic Unconfined Compressive Strength (f'uc) MPa	-
Minimum Shell Thickness (mm)	-
Weight	8.7
Units Per Tonne	-
Units Per Pallet	180
Units per Square Metre	-
Durability Class	Exposure Grade
Slip Resistance	
Wall Mass Inc Hollow	-
Solar Absorption Rating	-
LRV	-
FRL	-
EPD	Yes
Declare	No
Recycled Content %	-

Diagram

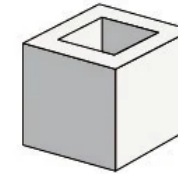

Fire Resistance Levels^

Structural Adequacy	-
Integrity	-
Insulation	-

Notes

-

Product Details

Product Range	GB Smooth
Texture Finish	Smooth
Colours	Nickel, Porcelain, Pottery, Pebble, Limestone & Pewter
Product Code	10.71 Standard Half Height
Format	10.71 Standard Half Height
Place of Manufacture	Gympie, Queensland
Length (mm)	390
Width (mm)	90
Height (mm)	90
Size	390x90x90
Core Volume (%)	-
Characteristic Unconfined Compressive Strength (f'uc) MPa	-
Minimum Shell Thickness (mm)	-
Weight	5.3
Units Per Tonne	-
Units Per Pallet	360
Units per Square Metre	-
Durability Class	Exposure Grade
Slip Resistance	
Wall Mass Inc Hollow	-
Solar Absorption Rating	-
LRV	-
FRL	-
EPD	Yes
Declare	No
Recycled Content %	-

Diagram

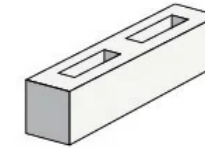

Fire Resistance Levels^

Structural Adequacy	-
Integrity	-
Insulation	-

Notes

-

Product Details

Product Range	GB Smooth
Texture Finish	Smooth
Colours	Nickel, Limestone, Pewter, Pebble & Porcelain
Product Code	20.45 Cleanout Block
Format	20.45 Cleanout Block
Place of Manufacture	Gympie, Queensland
Length (mm)	390
Width (mm)	190
Height (mm)	190
Size	390x190x190
Core Volume (%)	-
Characteristic Unconfined Compressive Strength (f'uc) MPa	-
Minimum Shell Thickness (mm)	-
Weight	15.625
Units Per Tonne	-
Units Per Pallet	90
Units per Square Metre	-
Durability Class	Exposure Grade
Slip Resistance	
Wall Mass Inc Hollow	-
Solar Absorption Rating	-
LRV	-
FRL	-
EPD	Yes
Declare	No
Recycled Content %	-

Diagram

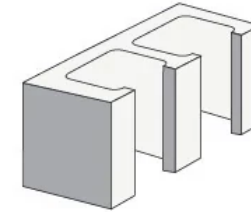

Fire Resistance Levels^

Structural Adequacy	-
Integrity	-
Insulation	-

Notes

-

Product Details

Product Range	GB Smooth
Texture Finish	Smooth
Colours	Limestone, Pebble, Pewter, Nickel & Porcelain
Product Code	10.01 Standard
Format	10.01 Standard
Place of Manufacture	Gympie, Queensland
Length (mm)	390
Width (mm)	90
Height (mm)	190
Size	390x90x190
Core Volume (%)	-
Characteristic Unconfined Compressive Strength (f'uc) MPa	-
Minimum Shell Thickness (mm)	-
Weight	10
Units Per Tonne	-
Units Per Pallet	180
Units per Square Metre	-
Durability Class	Exposure Grade
Slip Resistance	
Wall Mass Inc Hollow	-
Solar Absorption Rating	-
LRV	-
FRL	-
EPD	Yes
Declare	No
Recycled Content %	-

Diagram

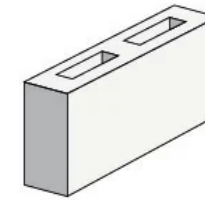

Fire Resistance Levels^

Structural Adequacy	-
Integrity	-
Insulation	-

Notes

-

Product Details

Product Range	GB Smooth
Texture Finish	Smooth
Colours	Limestone, Pebble, Nickel & Pewter
Product Code	20.38 Half Height Sill
Format	20.38 Half Height Sill
Place of Manufacture	Gympie, Queensland
Length (mm)	130
Width (mm)	190
Height (mm)	90
Size	130x190x90
Core Volume (%)	-
Characteristic Unconfined Compressive Strength (f'uc) MPa	-
Minimum Shell Thickness (mm)	-
Weight	8.3
Units Per Tonne	-
Units Per Pallet	224
Units per Square Metre	-
Durability Class	Exposure Grade
Slip Resistance	
Wall Mass Inc Hollow	-
Solar Absorption Rating	-
LRV	-
FRL	-
EPD	Yes
Declare	No
Recycled Content %	-

Diagram

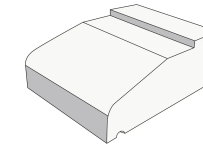

Fire Resistance Levels^

Structural Adequacy	-
Integrity	-
Insulation	-

Notes

-